

**ITEM 18. MOBILE CRANES – TEMPORARY ROAD CLOSURES – LITTLE  
BOURKE STREET SURRY HILLS**

**TRIM RECORD NO: 2017/432722**

**RECOMMENDATION**

It is recommended that the Committee endorse the temporary road closure of Little Bourke Street, Surry Hills, between Campbell and Bloomfield Streets, on Wednesday 15 November 2017 from 7am to 5pm, subject to the following conditions:

- (A) The Applicant must comply with the temporary road closure conditions as mentioned in Schedule B of this Agenda.
- (B) The Applicant must comply with any other conditions imposed by City's Construction Regulation Unit.
- (C) The Applicant has indicated Wednesday 13 December 2017 as an alternative date in case of inclement weather.
- (D) The Applicant must contact Surry Hills Police to obtain a separate police permit and to discuss deployment of user pay police for the road closure.
- (E) The Applicant must provide a telephone number of the supervisor responsible for the proposed closure and include contact details in the notification letters to be distributed to affected stakeholders.

**VOTING MEMBERS FOR THIS ITEM**

<b><i>Voting Members</i></b>	<b><i>Support</i></b>	<b><i>Object</i></b>
City of Sydney		
Roads and Maritime Services		
NSW Police – Surry Hills LAC		
Representative for the Member for Sydney		

**DECISION**

**BACKGROUND**

Manage Meant Pty Ltd has applied for the temporary road closure of Little Bourke Street, Surry Hills, between Campbell and Bloomfield Streets, on Wednesday 15 November 2017 from 7am to 5pm.

**COMMENTS**

The proposed temporary road closure is required to allow a mobile crane to undertake roof repairs at 175-185 Little Bourke Street, Surry Hills.

The Applicant has provided a site-specific Traffic Control Plan that includes details of barricades, signs, flagmen and other traffic devices to implement the proposed road closure.

There are currently no other approved temporary road closures proposed to take place on the same day in close proximity of this closure.

The temporary road closure will not affect any other properties, as local access will be provided at all times and alternative access routes are available nearby.

A Traffic Management Plan (TMP) for the temporary road closure was approved by Roads and Maritime Services (RMS).

### **CONSULTATION**

The Applicant will be required to notify affected stakeholders as stipulated in Schedule B.

### **FINANCIAL**

All costs associated with the proposed closure will be borne by the Applicant.

### **ATTACHMENTS**

Mobile Cranes – Temporary Road Closures – Little Bourke Street, Surry Hills

Claudia Calabro, Traffic Works Coordinator

# Manage Meant

## Little Bourke St

### Surry Hills

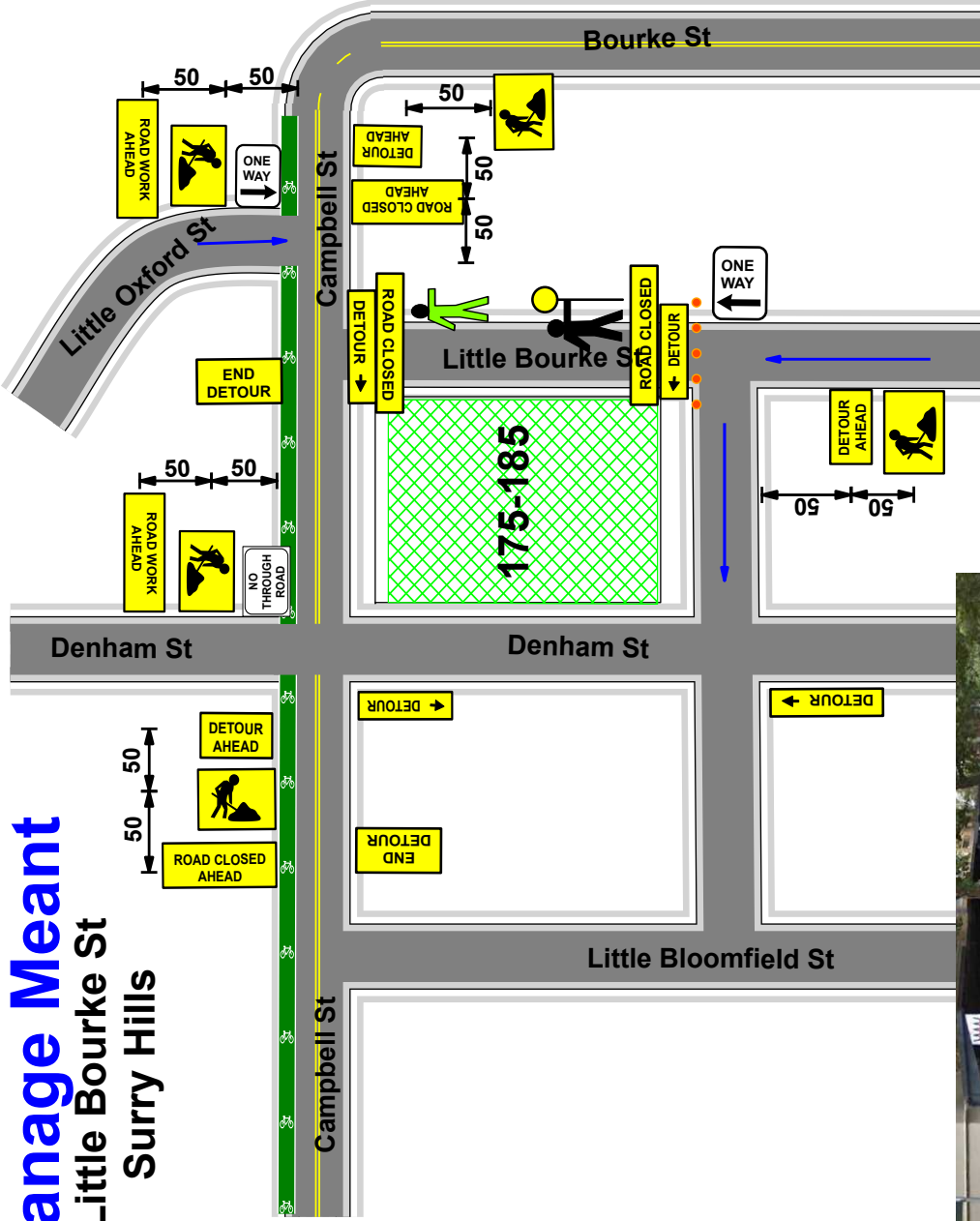

Modifications By-	Ticket No-	Time Modified-	Date Modified-	Plan No- <b>PTS0780</b>
Date: 23/08/2017 Author: DANNY WHITE Project: Manage Meant Road closed Detour Road Type: 2 Way Undivided Road Speed: 50 Km				Prepared & Signed by DANNY WHITE Cert No: 003660195
TRAFFIC CONTROLLER	CREW VEHICLE	C CLASS ARROW BOARD	AWV	OTHER EQUIPMENT:
1	1	1	1	TMA
TEAM LEADER				
1				

This plan shall be setup in accordance with AS 1742.3-2009 and Traffic Control Devices at Worksites The RTA "Traffic Control at Worksites Manual V4"  
 PLATINUM takes no responsibility for the implementation of this TCP when not directly involved in carrying out the subject works

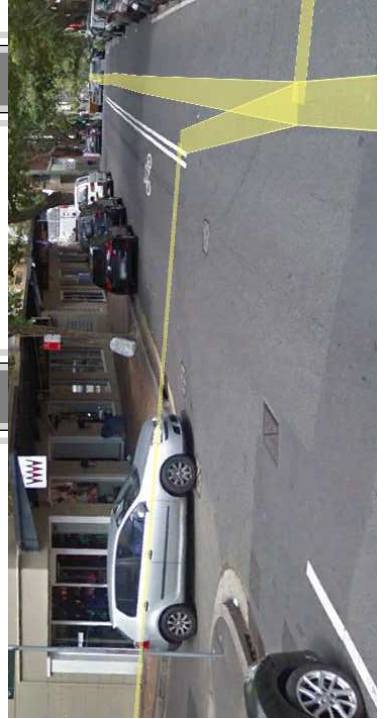

**GENERAL NOTES**  
 This site specific TCP is based on RMS TCAMS Manual and is to be setup and packed up by qualified traffic controllers with current Introduction to Traffic Control at Roadwork's (Yellow Card) any modifications made to this site specific TCP should be made by qualified personnel with current Select and Modify (Red Card) or Design and Inspect (Orange Card) all modifications to be signed off on this TCP along with certification number.  
 Plan shown is the property of Platinum Traffic Services.

RECOMMENDED TAPER LENGTH	APPROXIMATE SPEED OF TRAFFIC	LATERAL MERGE CONTROL AT BEGINNING OF TAPER	SHIFT OF TAPER
45 OR LESS	15	0	15
46-55	15	15	30
56-65	30	30	60
66-75	N/A	70	115
76-85	N/A	80	130
86-95	N/A	90	145
96-105	N/A	100	160
> 106	N/A	110	180

DIMENSION "D"	SPEED OF TRAFFIC	DIMENSION "D"
45 OR LESS	15m	15m
46 - 55	15m	15m
56 - 65	45m	EQUAL TO POSTED SPEED
GREATER THAN 65 K/M/H		

**TOLERANCES**  
 POSITIONING OF SIGNS  
 MINIMUM 10% LESS THAN THE DISTANCE OR LENGTHS GIVEN  
 MAXIMUM 25% MORE THAN THE DISTANCE OR LENGTHS GIVEN  
 SPACING OF DELINEATING DEVICES  
 MAXIMUM 10% MORE THAN THE SPACING GIVEN  
 NO MINIMUM

**PEDESTRIANS**  
 For works on and around footpath a minimum width of 1.2m shall be maintained at all times for pedestrians to pass unimpeded. If it is not possible to maintain this, pedestrians shall be directed onto roadway unless traffic controllers are used to control site and proper measures are put in place to conform with AS 1742.3

**NOTE**  
 TCP is Subjected to be Modified on site

